



VARLEY



rotacaster[™]
the ultimate in manoeuvrability

H Varley Limited
Materials Handling range

ROTACASTER

Catalogue MHR01



Materials Handling Range
rotacaster

Specification and product selection

All catalogue dimensions are in millimetres unless otherwise stated.

All catalogue load ratings are in kilogrammes unless otherwise stated.

Load ratings given are based on intermittent use on normal truck and trolley applications. Special conditions may apply under any of the following applications or hazards:

- Uneven floor surface
- Ramps, cracks, gullies, door guide rails
- Track or turntable use
- Power towing or driven wheels or rollers
- Any application other than manually propelled truck and trolley use

It may be appropriate to select a castor or wheel with a load capacity much greater than would appear necessary in a given set of circumstances, please ask our technical sales team for assistance in product selection.

Specifications (by dimension, description, illustration or otherwise) may be approximate and liable to change without notice, especially with regard to developments and improvements.

Listing of goods does not necessarily imply that they are ex-stock, nor do we accept any obligation to supply them.

All recommendations are given to the best of our knowledge and ability. No liability is accepted for their application.

Please refer to our Technical Information publication for more details.



CONTENTS

Introduction 2

Rotacasters

48mm Rotacasters	3
48mm Rotacasters, fork mounted	4
48mm Rotacasters, cup mounted	5
48mm Rotacaster accessories	6
125mm Rotacasters	7
125mm Rotacasters, fork mounted	8-9
125mm Rotacaster multimounts	10
125mm Rotacaster accessories	11

Rotatrucks

Benefits	12-13
Configurations, accessories, components	14-15

OTHER PAGES

Index	16
-------	----

H VARLEY has specialised in supplying the UK castor market since 1938, offering our customers the stability and strength they require. Our success has been achieved in responding to our customers' needs by offering:



PREFERRED RANGE



PRESSED STEEL CASTORS



FABRICATED STEEL CASTORS



SPECIAL APPLICATION CASTORS



SPECIAL APPLICATION WHEELS



MATERIALS HANDLING



ASSOCIATED PRODUCTS

Service and Support

A huge range of stock at our Altrincham warehouse and, at each of our locations, technical field sales representatives supported by knowledgeable and experienced sales office personnel. Our friendly and helpful staff will make sure your requirements are met accurately and rapidly with a next day delivery or same day trade counter collection.

Quality and Brands

H Varley takes pride in offering only the best quality branded products from the world's leading castor and wheel manufacturers – MANNER being no exception – to make certain our customers are consistently supplied with dependable, quality products to BS EN ISO 9001:2000.

Specification

We are continually exploring and developing our product ranges. By working closely with our suppliers and analysing market trends and requirements we endeavour to keep our customers informed and at the forefront of new technology and design with new product options available into both new and existing market places.

Market Prices

Price requirements are constantly monitored and reviewed with our suppliers to ensure our customers are consistently supplied at competitive market prices.

Rotacaster Wheel Limited (based in New South Wales, Australia) was formed in 2005 to produce the Rotacaster, an innovative omni-directional wheel that is most comparable to a swivel castor.

rotacaster™

The Rotacaster is the only multi-directional wheel technology developed primarily as an industrial and commercial floor wheel. The fixed orientation of its main wheel allows forward and reverse movement without fighting a swivel castor offset, while the peripheral rollers facilitate turning, rotational, lateral and diagonal movement. When navigating turns this also eliminates all skipping associated with



fixed wheels. Key benefits include:

- 360° manoeuvrability without turning or swivelling wheels
- Better directional control and tracking
- Precise positioning without swivel offset correction
- No resistance due to misaligned swivel castors
- Minimal wheel space/housing requirements
- Simple mounting. Choose from forks, cups, channels and rails or stack on an axle to form a roller wheel

The Rotacaster's unlimited manoeuvrability makes it a real alternative to a swivel castor and brings a whole new dimension of possibility to the design and functionality of wheeled products...

- Stability. A static load centre relative to wheel base
- Load distribution. The ability to use multiple wheels without swivel offset resistance
- The ability to tilt or lever off the fixed wheel mounting
- Robust. The combined wheel frame and roller axles provide a web like structure with over-moulded rollers
- Tough. Made from engineering grade polymers
- Rust free. Full polymer construction with no steel pins
- Non marking polyurethane rollers

Rotacasters offer a superb solution for multi-directional conveyor and load transfer needs. Built to provide the robustness and ride quality of an industrial wheel, the patented full polymer construction and 360° manoeuvrability bring a new level of performance to conveyor transfer and inverted multi-directional motion applications. Simple mounting options and a range of hubs make them easy to adapt to existing systems, both passive and driven. Injection moulded cup mounts provide the perfect alternative to a ball transfer unit.

Different wheel diameters and diameters provide the choices needed to handle light, sensitive, unstructured or heavy duty industrial level loads. Compact size allows more wheels per m² and minimal spacing between adjacent rollers for:

- Greater load distribution
- Reduced soft surface indentation
- Ability to handle a greater range of surface profiles



- 1 Rotacasters are available with either solid PBT or polyurethane rollers [illustrated] in a range of hardnesses
- 2 Rollers are plain bore or fitted with plain, acetal or nylon bushes
- 3 125mm diameter Rotacaster fitted with nylon bush, shielded or sealed [illustrated] low resistance precision ball journal bearings. 48mm Rotacaster with plain, hexagonal or keywayed bore
- 4 Rotacasters can move multidirectionally from static position - no swivel uptake
- 5 Pass-off ensures smooth running



As a complement to the omni-directional wheel, Rotacaster have developed a line of hand trucks, the Rotatruck, which provide improved manoeuvrability and require less effort than existing commercial grade products. The Rotatruck is designed such that it will support its own load without the operator exerting any effort to balance or support the load. The application of Rotacasters

on the self-supporting hand truck enables this functionality because of the unique Rotacaster design, which allows the truck to balance on four wheels without sacrificing range of motion or load stability. The Rotatruck is a commercial grade hand truck that requires less pull back effort, reduces operator fatigue, offers better durability and is priced comparably to the current industry standard.

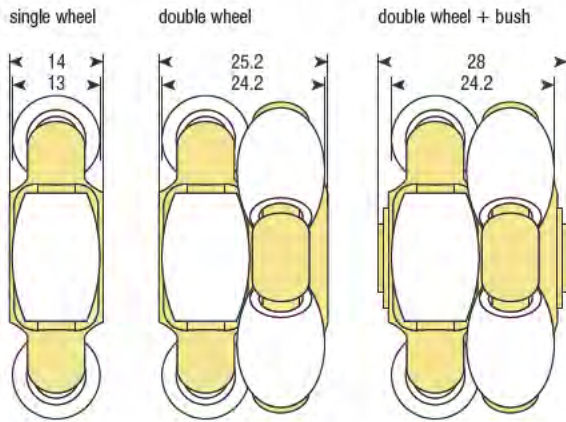

65A SHORE HARDNESS ORANGE POLYURETHANE ROLLER ON ACETAL BUSH

rotacaster diameter	roller diameter	type	bore size	load capacity **	plain bore	hexagonal	keywayed
48	13	single wheel	8	18			
		double wheel	8	18	R2-0484-6508	R1-0484-6568 R2-0484-6568	
		single wheel	11.1	18		R1-0484-6561 R2-0484-6561	
		double wheel	11.1	18			
		double wheel	12	18	R2-0484-6512		
		double wheel	12.7	18			R2-0484-6501

** Single wheels must be combined with an adjacent wheel indexed to form a continuous circular circumference - load capacity is based on two adjacent wheels

90A SHORE HARDNESS RED POLYURETHANE ROLLER ON ACETAL BUSH

rotacaster diameter	roller diameter	type	bore size	load capacity **	plain bore	hexagonal	keywayed
48	13	single wheel	8	30			
		double wheel	8	30	R2-0484-9008	R1-0484-9068 R2-0484-9068	
		single wheel	11.1	30		R1-0484-9061 R2-0484-9061	
		double wheel	11.1	30			
		double wheel	12	30	R2-0484-9012		
		double wheel	12.7	30			R2-0484-9001

** Single wheels must be combined with an adjacent wheel indexed to form a continuous circular circumference - load capacity is based on two adjacent wheels

SOLID GREY PBT* ROLLER, NO BUSH

rotacaster diameter	roller diameter	type	bore size	load capacity **	plain bore	hexagonal	keywayed
48	13	single wheel	8	40			
		double wheel	8	40	R2-0484-9908	R1-0484-9968 R2-0484-9968	
		single wheel	11.1	40		R1-0484-9961 R2-0484-9961	
		double wheel	11.1	40			
		double wheel	12	40	R2-0484-9912		
		double wheel	12.7	40			R2-0484-9901

* Polybutylene terephthalate

** Single wheels must be combined with an adjacent wheel indexed to form a continuous circular circumference - load capacity is based on two adjacent wheels



◀ ACETAL REDUCING BUSH FOR KEYWAYED ROTACASTER
6.35mm or 8mm bore
see page 6 for details.

I All dimensions are in mm and all loadings in kg unless otherwise stated

rotacaster
48mm
 fork mounted

- Double omni-directional wheel mounted in zinc plated pressed steel fork
- Variety of roller materials

rotacaster

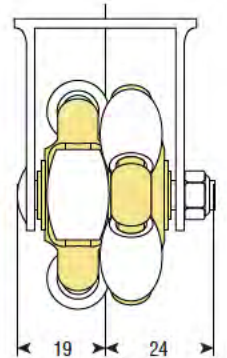
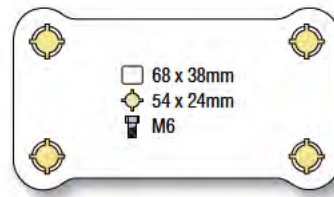

65A SHORE HARDNESS ORANGE POLYURETHANE ROLLER ON ACETAL BUSH

rotacaster diameter	roller diameter	type	fitted height	load capacity	pressed fork
48	13	double wheel	61	18	R2-0484-65/MF

90A SHORE HARDNESS RED POLYURETHANE ROLLER ON ACETAL BUSH

rotacaster diameter	roller diameter	type	fitted height	load capacity	pressed fork
48	13	double wheel	61	30	R2-0484-90/MF

SOLID GREY PBT* ROLLER, NO BUSH

rotacaster diameter	roller diameter	type	fitted height	load capacity	pressed fork
48	13	double wheel	61	40	R2-0484-99/MF

* Polybutylene terephthalate

i All dimensions are in mm and all loadings in kg unless otherwise stated



rotacaster

- Twin omni-directional wheels mounted in full polymer cup
- Variety of roller materials

rotacaster
48mm
cup mounted

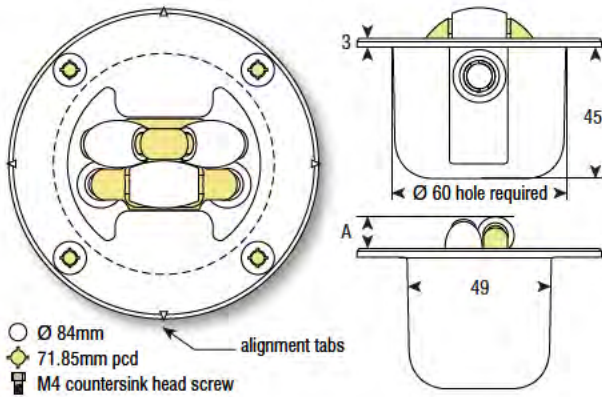

65A SHORE HARDNESS ORANGE POLYURETHANE ROLLER ON ACETAL BUSH

rotacaster diameter	roller diameter	A	load capacity	double wheel
48	13	4	18	R2-0484-65/MC04
		7		R2-0484-65/MC07
		11		R2-0484-65/MC11

90A SHORE HARDNESS RED POLYURETHANE ROLLER ON ACETAL BUSH

rotacaster diameter	roller diameter	A	load capacity	double wheel
48	13	4	30	R2-0484-90/MC04
		7		R2-0484-90/MC07
		11		R2-0484-90/MC11

SOLID GREY PBT* ROLLER, NO BUSH

rotacaster diameter	roller diameter	A	load capacity	double wheel
48	13	4	40	R2-0484-99/MC04
		7		R2-0484-99/MC07
		11		R2-0484-99/MC11

* Polybutylene terephthalate

1 All dimensions are in mm and all loadings in kg unless otherwise stated



ALUMINIUM CHANNEL



1 Rotacaster not included

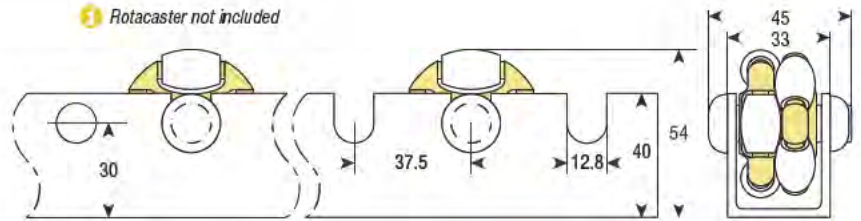

length	holed channel	slotted channel
3195	13-1308-13H	13-1308-13S

PLAIN MILD STEEL SHAFTS



diameter / size	length	round shaft	hexagonal shaft
8	3000	14-9702-08	
8 A/F	3000		14-9703-08
11.1 A/F	3000		14-9703-11
12	3000	14-9702-12	
12.7	3000	14-9702-13	

NYLON BUSHINGS / SPACERS



inside diameter	outside diameter	25.2mm length	50.4mm length	75.6mm length
8	12.7	13-9602-0813-025	13-9602-0813-050	
10	15.88	13-9602-1016-025	13-9602-1016-050	13-9602-1016-075
12	15.88	13-9602-1216-025	13-9602-1216-050	13-9602-1216-075
12.7 *	15.88	13-9602-1316-025	13-9602-1316-050	13-9602-1316-075

* also suitable for use with 11.1 A/F hexagonal shaft

NYLON AXLE CAPS

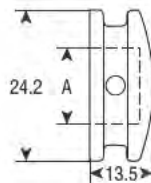

bore A	bush
12	13-2022-12
12.7 *	13-2022-13

* also suitable for use with 11.1 A/F hexagonal shaft

ACETAL AXLE AND RETAINER CAP

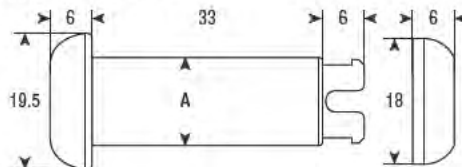

A	axle	cap
12.7 (nom.)	13-2002-13	13-2003-13

ACETAL FLANGED REDUCING BUSH TO SUIT KEYWAYED ROTACASTER

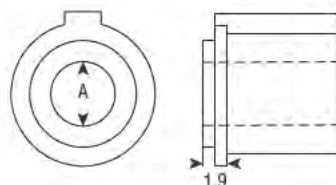

bore A	bush
6.35	13-9605-0713F
8	13-9605-0813F

1 All dimensions are in mm and all loadings in kg unless otherwise stated

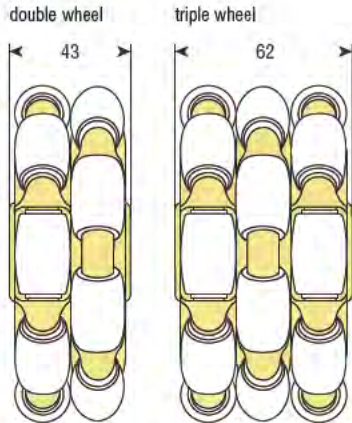

85A SHORE HARDNESS LIGHT GREY POLYURETHANE ROLLER ON NYLON BUSH

rotacaster diameter	roller diameter	type	bore size	load capacity *		nylon bush	shielded journal	sealed journal
				lateral	dynamic			
125	20	double wheel	8	68	115	R2-1258-85/N12 R2-1258-85/N13	R2-1258-85/Z09 R2-1258-85/Z10	R2-1258-85/S08
		double wheel	9.52	68	115			R2-1258-85/S10
		double wheel	10	68	115			R2-1258-85/S12
		double wheel	12	68	115			R2-1258-85/S13
		double wheel	12.7	68	115			R2-1258-85/S13

* Lateral load capacity refers to the maximum load capacity of each wheel to travel directly sideways without radial head contact. The dynamic load capacity (while in motion) ranges between the maximum static load capacity and the lateral load capacity and varies proportionally to speed of the wheel travelling in its primary direction

95A SHORE HARDNESS GREY POLYURETHANE ROLLER ON NYLON BUSH

rotacaster diameter	roller diameter	type	bore size	load capacity *		nylon bush	shielded journal	sealed journal
				lateral	dynamic			
125	20	double wheel	8	68	125	R2-1258-95/N12 R3-1258-95/N12 R2-1258-95/N13 R3-1258-95/N13	R2-1258-95/Z09 R3-1258-95/Z09 R2-1258-95/Z10 R3-1258-95/Z10	R2-1258-95/S08
		double wheel	9.52	68	125			R2-1258-95/S10
		triple wheel	9.52	80	160			R3-1258-95/S10
		double wheel	10	68	125			R2-1258-95/S12
		triple wheel	10	80	160			R3-1258-95/S12
		double wheel	12	68	125			R2-1258-95/S13
		triple wheel	12	80	160			R3-1258-95/S13
		double wheel	12.7	68	125			R2-1258-95/S13
		triple wheel	12.7	80	160			R3-1258-95/S13

* Lateral load capacity refers to the maximum load capacity of each wheel to travel directly sideways without radial head contact. The dynamic load capacity (while in motion) ranges between the maximum static load capacity and the lateral load capacity and varies proportionally to speed of the wheel travelling in its primary direction

All dimensions are in mm and all loadings in kg unless otherwise stated

rotacaster
125mm
 pressed fork mounted

- Omni-directional wheel mounted in zinc plated pressed steel fork
- Variety of roller materials

rotacaster



double wheel

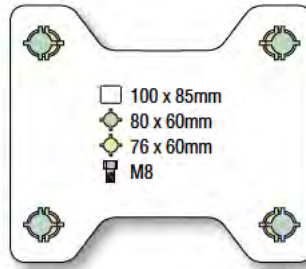

quad wheel

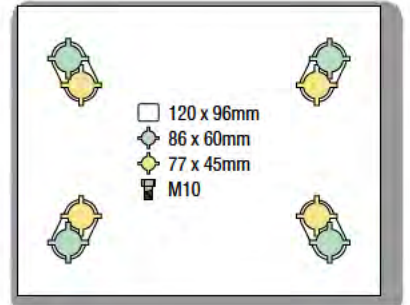

85A SHORE HARDNESS LIGHT GREY POLYURETHANE ROLLER ON NYLON BUSH

rotacaster diameter	roller diameter	type	fitted height	load capacity *		sealed journal 
				lateral	dynamic	
125	20	double wheel	141	68	125	R2-1258-85/MF
		quad wheel	134.5	120	220	R4-1258-85/MF

* Lateral load capacity refers to the maximum load capacity of each wheel to travel directly sideways without radial head contact. The dynamic load capacity (while in motion) ranges between the maximum static load capacity and the lateral load capacity and varies proportionally to speed of the wheel travelling in its primary direction

95A SHORE HARDNESS GREY POLYURETHANE ROLLER ON NYLON BUSH

rotacaster diameter	roller diameter	type	fitted height	load capacity *		sealed journal 
				lateral	dynamic	
125	20	double wheel	141	68	125	R2-1258-95/MF
		quad wheel	134.5	120	220	R4-1258-95/MF

* Lateral load capacity refers to the maximum load capacity of each wheel to travel directly sideways without radial head contact. The dynamic load capacity (while in motion) ranges between the maximum static load capacity and the lateral load capacity and varies proportionally to speed of the wheel travelling in its primary direction

 All dimensions are in mm and all loadings in kg unless otherwise stated



rotacaster

- Omni-directional wheel mounted in zinc plated fabricated steel fork
- Variety of roller materials

rotacaster
125mm
fabricated fork mounted



double wheel

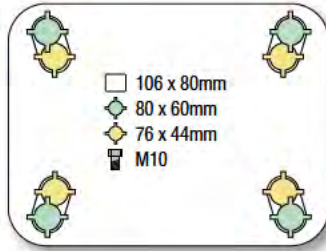

triple wheel

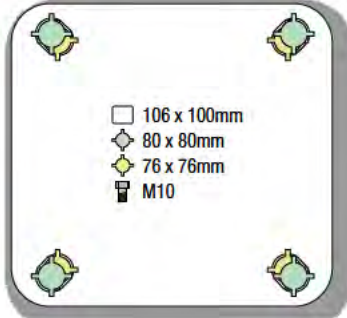

85A SHORE HARDNESS LIGHT GREY POLYURETHANE ROLLER ON NYLON BUSH

rotacaster diameter	roller diameter	type	fitted height	load capacity *		sealed journal 
				lateral	dynamic	
125	20	double wheel	155	68	125	R2-1258-85/MW

* Lateral load capacity refers to the maximum load capacity of each wheel to travel directly sideways without radial head contact. The dynamic load capacity (while in motion) ranges between the maximum static load capacity and the lateral load capacity and varies proportionally to speed of the wheel travelling in its primary direction

95A SHORE HARDNESS GREY POLYURETHANE ROLLER ON NYLON BUSH

rotacaster diameter	roller diameter	type	fitted height	load capacity *		sealed journal 
				lateral	dynamic	
125	20	double wheel	155	68	125	R2-1258-95/MW
		triple wheel	155	80	160	R3-1258-95/MW

* Lateral load capacity refers to the maximum load capacity of each wheel to travel directly sideways without radial head contact. The dynamic load capacity (while in motion) ranges between the maximum static load capacity and the lateral load capacity and varies proportionally to speed of the wheel travelling in its primary direction

 All dimensions are in mm and all loadings in kg unless otherwise stated

rotacaster
125mm
 multi mounts

- Omni-directional wheel mounted in zinc plated pressed steel channel
- Variety of roller materials

rotacaster

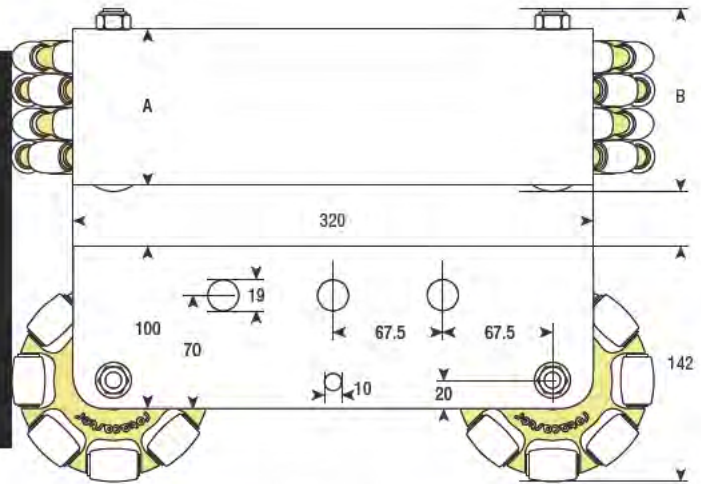

85A SHORE HARDNESS LIGHT GREY POLYURETHANE ROLLER ON NYLON BUSH

rotacaster diameter	roller diameter	type	A	B	load capacity * dynamic	2 rotacasters per channel	3 rotacasters per channel
125	20	double wheel	50	70	135	R2-1258-85/MM2	R2-1258-85/MM3
		double wheel	50	70	200		
		quad wheel	96	115	220	R4-1258-85/MM2	R4-1258-85/MM3
		quad wheel	96	115	300		

* The dynamic load capacity (while in motion) ranges between the maximum static load capacity and the lateral load capacity and varies proportionally to speed of the wheel travelling in its primary direction. 12mm and 1/2" bush may require hub refit.

95A SHORE HARDNESS LIGHT GREY POLYURETHANE ROLLER ON NYLON BUSH

rotacaster diameter	roller diameter	type	A	B	load capacity * dynamic	2 rotacasters per channel	3 rotacasters per channel
125	20	double wheel	50	70	165	R2-1258-95/MM2	R2-1258-95/MM3
		double wheel	50	70	240		
		triple wheel	69	85	220	R3-1258-95/MM2	R3-1258-95/MM3
		triple wheel	69	85	300		
		quad wheel	96	115	250	R4-1258-95/MM2	R4-1258-95/MM3
		quad wheel	96	115	340		

* The dynamic load capacity (while in motion) ranges between the maximum static load capacity and the lateral load capacity and varies proportionally to speed of the wheel travelling in its primary direction. 12mm and 1/2" bush may require hub refit.



◀ **1100MM MOUNT CHANNEL**

Build a multi mount to your own specification using 1100mm channel and 125mm Rotacasters
 Channel only order ref 11-9110

1 All dimensions are in mm and all loadings in kg unless otherwise stated



NYLON BUSHINGS / SPACERS



inside diameter	outside diameter	25.2mm length	50.4mm length	75.6mm length
8	12.7	13-9602-0813-025	13-9602-0813-050	
10	15.88	13-9602-1016-025	13-9602-1016-050	13-9602-1016-075
12	15.88	13-9602-1216-025	13-9602-1216-050	13-9602-1216-075
12.7	15.88	13-9602-1316-025	13-9602-1316-050	13-9602-1316-075

NYLON AXLE CAPS

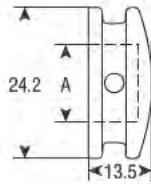

bore A	bush
12	13-2022-12
12.7	13-2022-13

All dimensions are in mm and all loadings in kg unless otherwise stated

Rotatruck benefits

- Health and safety benefits of Rotatruck
- Rotatruck improves both ergonomic safety and productivity delivering immediate return on investment

rotacaster™



REDUCED EFFORT as Rotatruck carries the load, not the operator

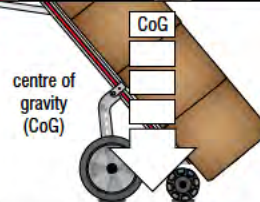

ROTATRUCK FULLY SUPPORTS LOAD on configurable, multi-directional wheel base



EASIER PULL BACK EFFORT and no need park at waypoints

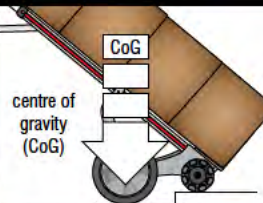

LEVER RATHER THAN LIFT the load up kerbs or over obstructions without reversing

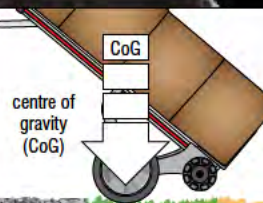

BALANCE RATHER THAN CARRY the load over soft or uneven terrain



FULLY SUPPORTED ROTATION allows easy manoeuvrability in confined spaces

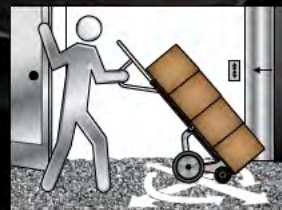

EASY NAVIGATION frees up hands to deal with doorways and intercoms



rotacaster

Rotatruck performance vs. traditionally configured handtruck

Rotatruck
Rotatruck vs.
handtruck



ROTATRUCK vs. handtruck

PULL-BACKS



Easier pull back effort and no need to park at waypoints

LOAD SUPPORT



Reduced effort. The Rotatruck carries the load, not the operator

CURBS & OBSTRUCTIONS

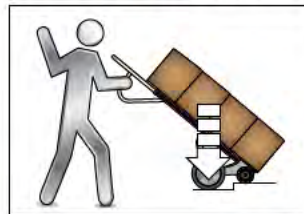

Lever rather than lift the load up curbs or over obstructions without reversing

SOFT, UNEVEN TERRAIN

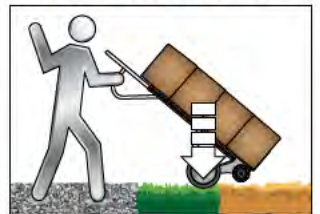

Balance rather than carry the load over soft or uneven terrain



Need to park and pull back loads at waypoints, increasing strain on musculoskeletal structure



Requires constant operator input to maintain load balance exerting strain and effort

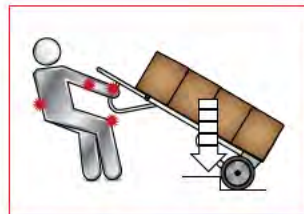

Operator exerts maximum effort to reverse and pull load up and over curbs



Operator carries increased share of load to safely move across terrain

Rotatruck

popular configurations
accessories

Popular Rotatruck configurations can be adapted to your application by choosing from a range of accessories

rotacaster



2 x R3 ROTACASTERS 2 x FOAM FILLED WHEELS

- Standard frame
- Extended vertical loop handle



rotacaster diameter	rear wheel diameter	rotatruck
125	250	11-2325-16/R3

2 x R3 ROTACASTERS 2 x BALLOON CUSHION WHEELS

- Standard frame
- Extended vertical loop handle



rotacaster diameter	rear wheel diameter	rotatruck
125	200	11-2315-16/R3
125	250	11-2316-16/R3

4 x R3 ROTACASTERS

- Standard frame
- Standard vertical loop handle



rotacaster diameter	rotatruck
125	11-2312-13/R3

2 x R3 ROTACASTERS 2 x CAST ALUMINIUM WHEELS WITH RUBBER TYRE

- Standard frame
- Standard loop handle



rotacaster diameter	rear wheel diameter	rotatruck
125	200	11-2314-10/R3

2 x R3 ROTACASTERS 2 x R3 STAIRCLIMBER ROTACASTER WHEELS

- Standard frame
- Extended vertical loop handle



rotacaster diameter	rotatruck
125	11-2360-16/R3

ROTATRUCK ACCESSORIES



All dimensions are in mm and all loadings in kg unless otherwise stated



rotacaster

- Rotatrucks can be built to order in any combination of components for specific applications
- Conversion kits available to upgrade standard hand trucks

Rotatruck

special applications
conversion kits
components

SPECIAL APPLICATION ROTATRUCKS

Wide load wings



Milk crate



Bread crate



Multi-load



LPG / gas



Keg



ROTATRUCK CONVERSION KITS

Convert your existing handtruck. Rotacaster conversion kits are compatible with most modular handtrucks and can be adapted to others, making the conversion to a Rotatruck simple and cost effective.



ROTATRUCK COMPONENTS

Combine components to create a Rotatruck suited to your application

	Chassis. All-terrain, 250mm foam filled rear wheels		Chassis. All-terrain, 250mm balloon cushion rear wheels		Chassis. 125mm rotacasters
	Chassis. All-terrain, 200mm balloon cushion rear wheels		Chassis. 200mm Aluminium rear wheels with rubber tyres		Chassis. Rotacaster stairclimber rear wheels
	Frame. Standard		Frame. Hi-stress		Frame. Curved
	Handle. Standard loop		Handle. Vertical loop		Handle. Extended vertical loop
	Handle. Double vertical loop		Toe. Cast		Toe. Extruded
	Rotacaster. R2 125mm double wheel		Rotacaster. R3 125mm triple wheel		

Rotatruck components can be set up to suit load

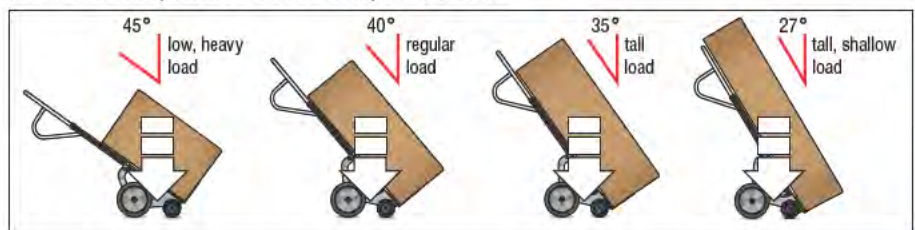



11-9110	10	R1-0484-9061	3	R2-1258-95/MW	9
11-2312-13/R3	12	R1-0484-9068	3	R2-1258-95/N12	7
11-2314-10/R3	12	R1-0484-9961	3	R2-1258-95/N13	7
11-2315-16/R3	12	R1-0484-9968	3	R2-1258-95/S08	7
11-2316-16/R3	12	R2-0484-65/MC04	5	R2-1258-95/S10	7
11-2325-16/R3	12	R2-0484-65/MC07	5	R2-1258-95/S12	7
11-2360-16/R3	12	R2-0484-65/MC11	5	R2-1258-95/S13	7
13-1308-13H	6	R2-0484-65/MF	4	R2-1258-95/Z09	7
13-1308-13S	6	R2-0484-6501	3	R2-1258-95/Z10	7
13-2002-13	6	R2-0484-6508	3	R3-1258-95/MM2	10
13-2003-13	6	R2-0484-6512	3	R3-1258-95/MM3	10
13-2022-12	6	R2-0484-6561	3	R3-1258-95/MW	9
13-2022-12	11	R2-0484-6568	3	R3-1258-95/N12	7
13-2022-13	6	R2-0484-90/MC04	5	R3-1258-95/N13	7
13-2022-13	11	R2-0484-90/MC07	5	R3-1258-95/S10	7
13-9602-0813-025	6	R2-0484-90/MC11	5	R3-1258-95/S12	7
13-9602-0813-025	11	R2-0484-90/MF	4	R3-1258-95/S13	7
13-9602-0813-050	6	R2-0484-9001	3	R3-1258-95/Z09	7
13-9602-0813-050	11	R2-0484-9008	3	R3-1258-95/Z10	7
13-9602-1016-025	6	R2-0484-9012	3	R4-1258-85/MF	8
13-9602-1016-025	11	R2-0484-9061	3	R4-1258-85/MM2	10
13-9602-1016-050	6	R2-0484-9068	3	R4-1258-85/MM3	10
13-9602-1016-050	11	R2-0484-99/MC04	5	R4-1258-95/MF	8
13-9602-1016-075	6	R2-0484-99/MC07	5	R4-1258-95/MM2	10
13-9602-1016-075	11	R2-0484-99/MC11	5	R4-1258-95/MM3	10
13-9602-1216-025	6	R2-0484-99/MF	4		
13-9602-1216-025	11	R2-0484-9901	3		
13-9602-1216-050	6	R2-0484-9908	3		
13-9602-1216-050	11	R2-0484-9912	3		
13-9602-1216-075	6	R2-0484-9961	3		
13-9602-1216-075	11	R2-0484-9968	3		
13-9602-1316-025	6	R2-1258-85/MF	8		
13-9602-1316-025	11	R2-1258-85/MM2	10		
13-9602-1316-050	6	R2-1258-85/MM3	10		
13-9602-1316-050	11	R2-1258-85/MW	9		
13-9602-1316-075	6	R2-1258-85/N12	7		
13-9602-1316-075	11	R2-1258-85/N13	7		
13-9605-0713F	6	R2-1258-85/S08	7		
13-9605-0813F	6	R2-1258-85/S10	7		
14-9702-08	6	R2-1258-85/S12	7		
14-9702-12	6	R2-1258-85/S13	7		
14-9702-13	6	R2-1258-85/Z09	7		
14-9703-08	6	R2-1258-85/Z10	7		
14-9703-11	6	R2-1258-95/MF	8		
R1-0484-6561	3	R2-1258-95/MM2	10		
R1-0484-6568	3	R2-1258-95/MM3	10		

Head Office and Warehouse



Unit 5 Century Park
Pacific Road Broadheath
Altrincham Cheshire
WA14 5BJ

t 0161 928 9617

f 0161 928 7824

e nthsales@varley.co.uk

Scotland and the North East

t 01698 732523

f 01698 730947

e scotsales@varley.co.uk

Midlands and the South

t 01952 462527

f 01952 460176

e midsales@varley.co.uk

w www.varley.co.uk

H Varley Limited
Materials Handling range

ROTACASTER series

Catalogue MHR01



Cert. No. Q10773