

## 2V20A | NY | PLATE FIXING

NYLON WHEEL

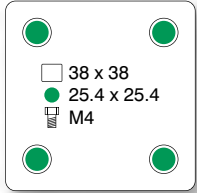

wheel diameter	fitted height	load capacity	bearing type	swivel	fixed	swivel + total-stop brake
40	56	40	plain	<a href="#">2V20A 040 NYP PX1</a>		<a href="#">2V22A 040 NYP PX1</a>
45	60	45	plain	<a href="#">2V20A 045 NYP PX1</a>		<a href="#">2V22A 045 NYP PX1</a>
50	64	50	plain	<a href="#">2V20A 050 NYP PX1</a>		<a href="#">2V22A 050 NYP PX1</a>

## 2V20A | NY | THREAD FIXING

NYLON WHEEL

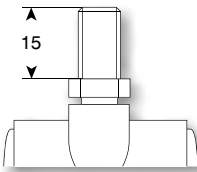

wheel diameter	fitted height	load capacity	bearing type	thread size	swivel	fixed	swivel + total-stop brake
40	50	40	plain	M8	<a href="#">2V20A 040 NYP T08</a>		<a href="#">2V22A 040 NYP T08</a>
	50	40	plain	M10	<a href="#">2V20A 040 NYP T10</a>		<a href="#">2V22A 040 NYP T10</a>
45	54	45	plain	M8	<a href="#">2V20A 045 NYP T08</a>		<a href="#">2V22A 045 NYP T08</a>
	54	45	plain	M10	<a href="#">2V20A 045 NYP T10</a>		<a href="#">2V22A 045 NYP T10</a>
50	59	50	plain	M8	<a href="#">2V20A 050 NYP T08</a>		<a href="#">2V22A 050 NYP T08</a>
	59	50	plain	M10	<a href="#">2V20A 050 NYP T10</a>		<a href="#">2V22A 050 NYP T10</a>

**i** All dimensions are in **mm** and all loadings are in **kg** unless otherwise stated

## 2V20A | NY | SOCKET FIXING

NYLON WHEEL

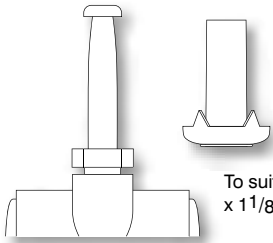

To suit 3/8" diameter  
x 1 1/8" hole in wood



wheel diameter	fitted height	load capacity	bearing type	swivel	fixed	swivel + total-stop brake
40	56	40	plain	<a href="#">2V20A 040 NYP SS1</a>		<a href="#">2V22A 040 NYP SS1</a>
45	60	45	plain	<a href="#">2V20A 045 NYP SS1</a>		<a href="#">2V22A 045 NYP SS1</a>
50	64	50	plain	<a href="#">2V20A 050 NYP SS1</a>		<a href="#">2V22A 050 NYP SS1</a>

## 2V20A | NY | STEM FIXING

NYLON WHEEL

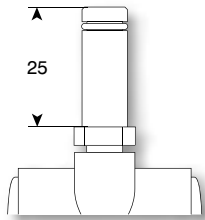

wheel diameter	fitted height	load capacity	bearing type	stem size	swivel	fixed	swivel + total-stop brake
40	52	40	plain	10	<a href="#">2V20A 040 NYP CS1</a>		<a href="#">2V22A 040 NYP CS1</a>
	52	40	plain	11	<a href="#">2V20A 040 NYP CS2</a>		<a href="#">2V22A 040 NYP CS2</a>
45	54	45	plain	10	<a href="#">2V20A 045 NYP CS1</a>		<a href="#">2V22A 045 NYP CS1</a>
	54	45	plain	11	<a href="#">2V20A 045 NYP CS2</a>		<a href="#">2V22A 045 NYP CS2</a>
50	59	50	plain	10	<a href="#">2V20A 050 NYP CS1</a>		<a href="#">2V22A 050 NYP CS1</a>
	59	50	plain	11	<a href="#">2V20A 050 NYP CS2</a>		<a href="#">2V22A 050 NYP CS2</a>

**i** All dimensions are in **mm** and all loadings are in **kg** unless otherwise stated