

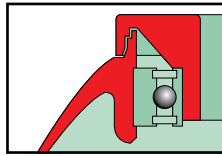

manner



- Anti-static / conductive / ESD. Resistivity < 10kΩ
- Contemporary design
- Corrosion resistant polyamide construction
- Plate, bolt hole or bolt fixing
- Precision ball bearing in swivel head
- Labyrinth seal for protection in wet conditions

TANGO AX MKL AX GKL AX

TANGO + ANTI-STATIC THERMOELASTIC RUBBER TYRED WHEEL WITH POLYPROPYLENE CENTRE - PLATE FIXING

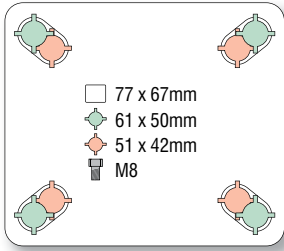

i Total stop castors: yellow pedal
 Directional lock castors: dark grey pedal

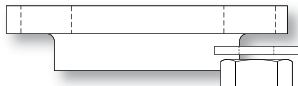

washer min Ø18mm
 ⚙ tighten max 12Nm

wheel diameter	tread width	fitted height	swivel offset	shore A	load capacity	bearing type	swivel	fixed	swivel + total stop brake	swivel + directional lock
75	32	117	35.5	86	70	ball	MKL-S-75 PTE/K AX		MKL-JY-S-75 PTE/K AX	MKL-R-S-75 PTE/K AX
100	32	148	45	86	100	ball	GKL-S-100 PTE/K AX		GKL-JY-S-100 PTE/K AX	GKL-R-S-100 PTE/K AX
125	32	168	44.5	86	100	ball	GKL-S-125 PTE/K AX		GKL-JY-S-125 PTE/K AX	GKL-R-S-125 PTE/K AX

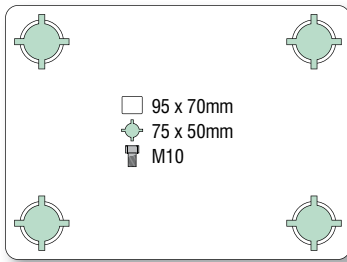

◀ ALTERNATIVE TOP PLATE.
 Available on all castors.
 Add **95X70** to castor reference.

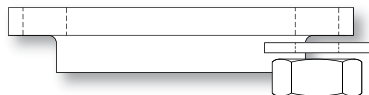

washer min Ø20mm
 ⚙ tighten max 15Nm