

V | TYPE J | THREAD FIXING

MILD STEEL BALL

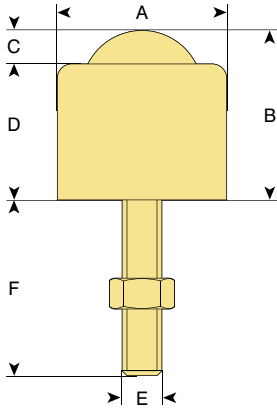

UNITS WITH MILD STEEL BALL

ball dia.	A	B	C	D	E	F	ball up load	ball down load	ref
12	20	20	2	17	M6	28	25	n/a	V12J
19	30	30	4	26	M8	25	50	n/a	V19J
25	35	35	7	28	M8	40	125	n/a	V25J



All dimensions are in **mm** and all loadings are in **kg** unless otherwise stated